

Central Heating Module

Model 2100-DG-0600 (Diesel, NG or LP Gas)

Features

- Unit comes standard with a diesel burner but with a burner change can be configured to run on propane or natural gas as well.
- Temperature control and fuel usage is automatic.
- Patented "Combustion Environment Control" system preheats fuel and air to optimum temperatures prior to entering the burner for combustion. No need to adjust the burner to keep up with changing weather conditions.
- Compact and portable design for easy positioning on the work site.
- All system operation is controlled and monitored from the central heating module control panel.
- 8-light system operation feature for easy system troubleshooting.
- Fluid circulation system is low pressure and atmospherically vented. There is no chance of an explosion or line burst due to pressure build-up. No special boiler certification is required to operate the system.
- A "rapid air elimination" feature ensures quick setup-and-go operation.
- Conforms to most special job requirements due to its modular nature.

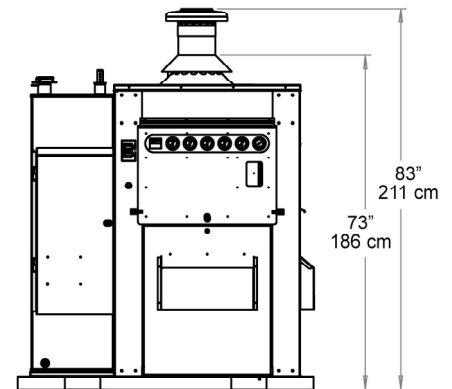
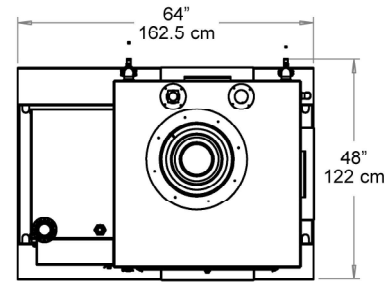

Specifications

Diesel Burner	Single stage Diesel fuel/#1 or 2 heating oil 82% efficient
Input capacity	620,200 BTUH, 182 KW
Output capacity	508,564 BTUH, 149 KW
Fuel consumption	4.43 US GPH, 16.8 LPH, 14.3 KG/H
Natural Gas	
Input capacity	530,400 BTUH/H
Consumption (100% run time)	15 Cubic Metres per Hour
Propane	
Input capacity	603,840 BTUH/H
Consumption (100% run time)	25 Litres per Hour
Weight	Dry - 1,500 LB., 680 KG Wet - 2,700 LB., 1,225 KG
Electrical	Single phase, 115/230 V, 60 Hz, 20 Amps
Loading - standard.....	Forklift pockets on all sides
Heat exchanger.....	Water jacket / fire tube type
.....	Fluid volume - 25 US Gal., 94.6 L
.....	Fluid temp. range - 120°F to 200°F, 49°C to 93°C
Fuel tank	Welded steel
.....	Fuel capacity - 130 US Gal., 492 L
.....	29.3 hr operating range at full output
Climate control system	Maintains optimum burner reliability and efficiency at a full range of ambient temperature conditions. Assures system start-up and operation in all conditions.
"Before system start-up"	
....Pre-heater	4000 Watt electric circulation heater, 240V, Preheats heat exchanger glycol before system start-up.

"During system operation"Fuel heater.....
....Combustion air heater	
Control & monitoring	
Internal fluid circulation system	Basic features.....
Circulation pump	
.....	
.....	
Primary circulation.....	
.....	
Heat transfer fluid (HTF)	
.....	
Lock-out.....	

Automatically maintains set fuel temperature. Fluid (hot glycol)-to-fluid (fuel) heat transfer.

Automatically maintains set combustion air temperature. Fluid (hot glycol)-to-air heat transfer utilizing a heat transfer coil. Pump & temperature controls.

Full gauge panel showing circulation fluid temperatures & pressures, fuel pressures. 8-light system operation feature for easy system troubleshooting.

Atmospherically vented, low pressure. Single supply & return. Adjustable fluid temperature control. Auto pressure by-pass for pump protection and variable flow demands. Auto temperature bypass for heat exchanger protection.

RPM - 2900 RPM
1-1/2 HP, 1.1KW
Flow - 50 US GPM @ 30 P.S.I
11.34 M³/HR @ 21 M W.C.

Fluid circulation lines - 1-1/2", 40 MM
Ball valves - 1-1/2", 40 MM
Kamlock quick couplers - 1-1/2", 40 MM
Non-toxic propylene glycol / water mixture. Freeze protected.

Locks out primary fluid circulation valves and control panel.



Heat Thaw Cure Dry

1-888-750-1700

www.dryair.ca

DRYAIR Manufacturing Corp.
400 Service Rd.
St. Brieux, SK
Canada, S0K 3V0