

PRODUCT SPECS

PLATE HEAT EXCHANGER

HEFF 1M SERIES II

For high-rise heating applications and for boiler tie-ins



FEATURES

The HEFF 1M Series II uses a fluid-to-fluid plate heat exchanger to produce a fluid distribution loop separate from the heating unit. A 3 hp pump in the HEFF 1M Series II allows it to circulate fluid up to 70' vertically in high-rise heating applications.

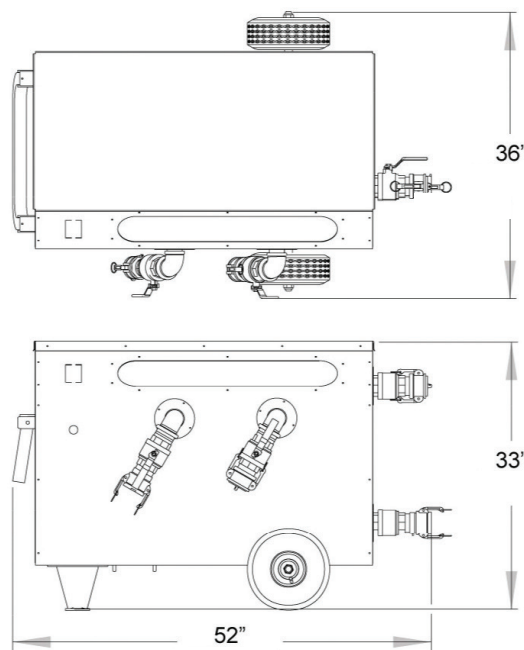

SPECIFICATIONS

Output	1.8 million Btu/h
Weight (wet)	500 lbs
Electrical	230 V, single phase, 60 Hz, 30 A
Pump	3,500 rpm
.....	3 hp
.....	Flow - 80 US gpm @ 35 psi
Controls	
+ Monitoring	Pressure gauge for heat exchange circulation loop
.....	Supply and return temperature gauge for boiler circulation loop
.....	Supply and return temperature gauge for heat exchanger circulation loop
.....	Pump control switch (on - off)

Fluid Circulation

Central heating module circulation loop

.....	Single supply and return
.....	Kamlok® quick couplers and ball valves - 2"

Plate heat exchanger circulation loop

.....	Single supply and return - 2" Kamlok® quick couplers and ball valves
.....	Primary circulation line - 1 1/2" primary circulation lines can be used for applications using up to 400 ft of line. 2" primary circulation lines must be used for application over 400 ft of line.



400 Service Road, St. Brieux, SK, S0K 3V0, Canada
1-888-750-1700 | WWW.DRYAIR.CA